

Property Division Map

Town
of
Rock

T. 2 N. - R. 12 E.
Section 26 SE

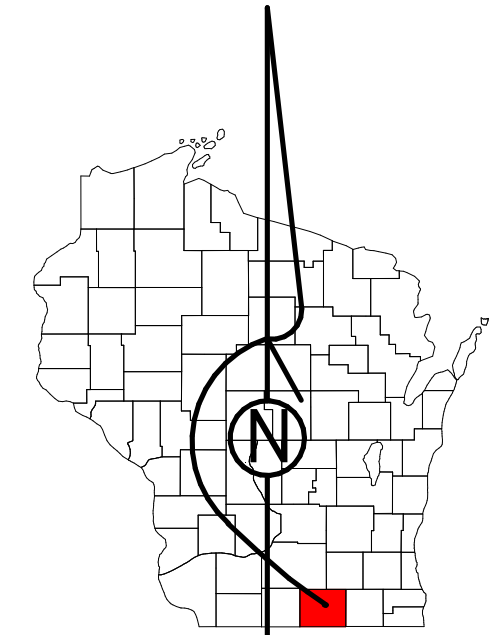

STATE OF WISCONSIN
COUNTY OF ROCK

PREPARED BY

REAL PROPERTY DESCRIPTION
DEPARTMENT

USING

ROCK COUNTY
GEOGRAPHIC INFORMATION SYSTEM

DUPLICATION OF THIS MAP PROHIBITED
WITHOUT THE WRITTEN CONSENT OF THE
REAL PROPERTY DESCRIPTION DEPARTMENT.

THIS MAP WAS PREPARED PURSUANT
TO SECTION 76.09 WIS. STATS.
USING PUBLIC RECORDS. IT IS NOT INTENDED
TO BE A SUBSTITUTE FOR AN
ACTUAL FIELD SURVEY
AND IS ADVISORY ONLY.

DISTANCES SHOWN ON THIS
MAP WERE PRODUCED BY
THE GIS SYSTEM AND ARE
FOR REFERENCE ONLY.
SEE DOCUMENT OF RECORD
FOR ACTUAL DISTANCE.

0 25 50 100 150 200 Feet

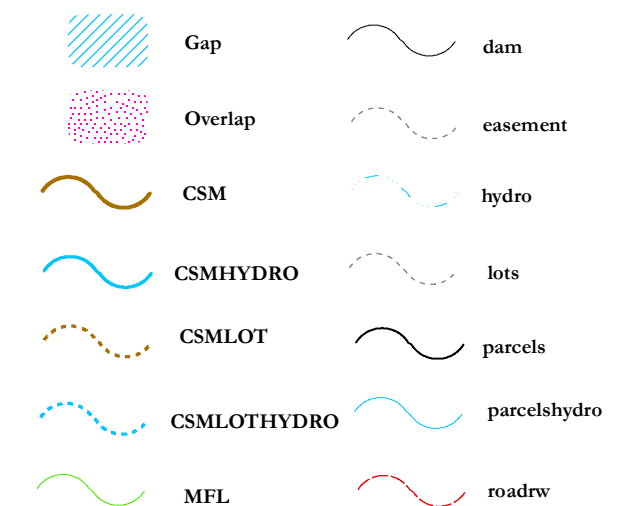

See Pages

January 1, 2023

26 SE

26 NE

6-17-244.6
MICHEAL J BLASER
KATHY J BLASER
20.22 A

6-17-244.13
ROCK CO CHRISTIAN SCHOOL
8.08 A

6-17-245
COUNTY OF ROCK
HAPPY HOLLOW PARK
38.38 A

6-17-243
JULIA A BERGENDAL
38.02 A

6-17-243A
COUNTY OF ROCK
HAPPY HOLLOW PARK
8.1 A

6-17-321
COUNTY OF ROCK
HAPPY HOLLOW PARK
32.54 A

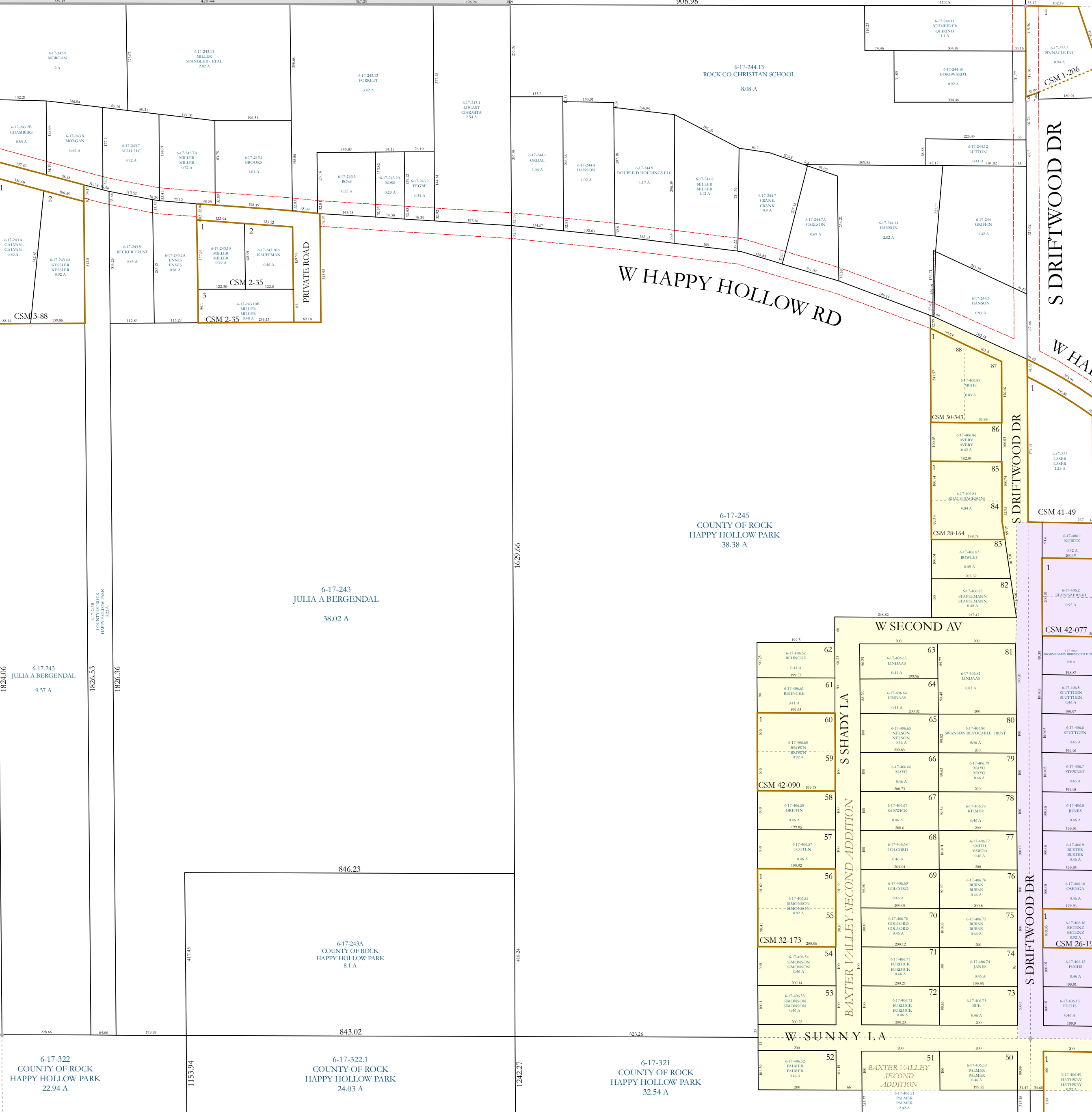

26 SW

PT GL 2
6-17-232
COUNTY OF ROCK
HAPPY HOLLOW PARK
55.91 A

6-17-243
JULIA A BERGENDAL
9.57 A

6-17-322
COUNTY OF ROCK
HAPPY HOLLOW PARK
22.94 A

6-17-321
COUNTY OF ROCK
HAPPY HOLLOW PARK
24.03 A

35 NE

25 SW