

20 NE

STATE OF WISCONSIN
DEPARTMENT OF NATURAL RESOURCES
850 S.A.

Duck Lake

6-13-157
MHC BLACKHAWK LLC
26.17 A

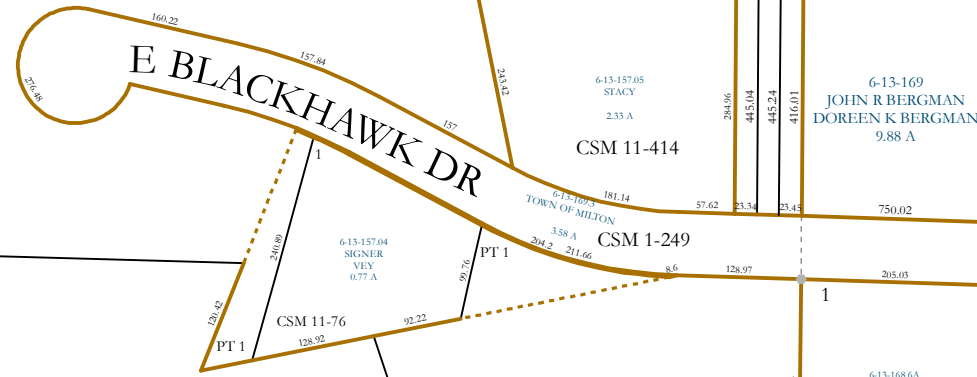

Property Division Map

Town
of
Milton

T. 4 N. - R. 13 E.
Section 20 SE

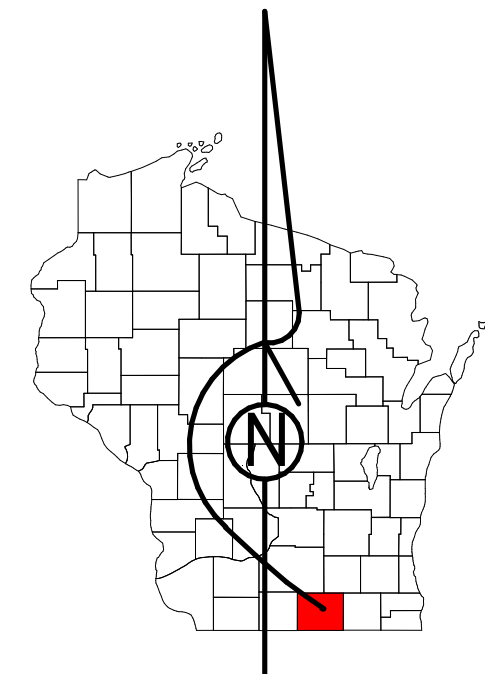

STATE OF WISCONSIN
COUNTY OF ROCK

PREPARED BY















REAL PROPERTY DESCRIPTION
DEPARTMENT
USING
ROCK COUNTY
GEOGRAPHIC INFORMATION SYSTEM

DUPLICATION OF THIS MAP PROHIBITED
WITHOUT THE WRITTEN CONSENT OF THE
REAL PROPERTY DESCRIPTION DEPARTMENT.

THIS MAP WAS PREPARED PURSUANT
TO SECTION 70.09 WIS. STATS.
USING PUBLIC RECORDS. IT IS NOT INTENDED
TO BE A SUBSTITUTE FOR AN
ACTUAL FIELD SURVEY
AND IS ADVISORY ONLY.

DISTANCES SHOWN ON THIS
MAP WERE PRODUCED BY
THE GIS SYSTEM AND ARE
FOR REFERENCE ONLY.
SEE DOCUMENT OF RECORD
FOR ACTUAL DISTANCE.

0 25 50 100 150 200
Feet

-  Gap
-  Overlap
-  CSM
-  CSMHYDRO
-  CSMLOT
-  CSMLOTHYDRO
-  MFL
-  dam
-  easement
-  hydro
-  lots
-  parcels
-  parcelshydro
-  roadrw

See Pages

January 1, 2023

20 SE

6-13-160
ADELINE J. - TRUSTEE RIESTER REVOCABLE TRUST
118.3 A

6-13-164
MHC BLACKHAWK LLC
40.15 A

6-13-162.1
MHC BLACKHAWK LLC
14.87 A

6-13-162
MHC BLACKHAWK LLC
24.88 A

6-13-168
CRAZY ACRES II LLC
44.45 A

6-13-633.3
BORNEMAN
BORNEMAN
5.54 A

6-13-633.4
BORNEMAN
BORNEMAN
6.15 A

6-13-633.5
KOZAK REVOCABLE TRUST
7.45 A

6-13-633.6
WEIBERHAL
WEIBERHAL
4.06 A

6-13-161
RONALD L. PETT
34.28 A

6-13-633.1
SCHWITZER
SCHWITZER
2.36 A

6-13-163
DOUGLAS F. ARNOLD
JOAN P. ARNOLD
18.69 A

6-13-221
PETT
6.55 A

6-13-213.1
FRANK HOLDINGS INC
3.99 A

6-13-219
DOUGLAS F. ARNOLD
JOAN P. ARNOLD
18.75 A

