

896.19

850.73

836.42

OLD HY 11

OL 1

CSM 34-137

6-24-404
CRAIG A CASE
14.41 A

63 64 65
6-24-17545
SPEJEL REVOCABLE TRUST
0.32 A
6-24-17544
TURNER
0.29 A
6-24-17546
MARTINSON
MARTINSON
0.32 A

GAVIN DR

COUNTRYVIEW ESTATES PLAT
NO. 4

BRETT'S WY

BRETT'S WY

COMFORT COVE ST

ESTATES PLAT

ESTATES PLAT NO. 3

ESTATES PLAT

ERIMEST

18 SWSW

Property Division Map

Village
of
Orfordville

T. 2 N. - R. 10 E.

Section 18 NWSW

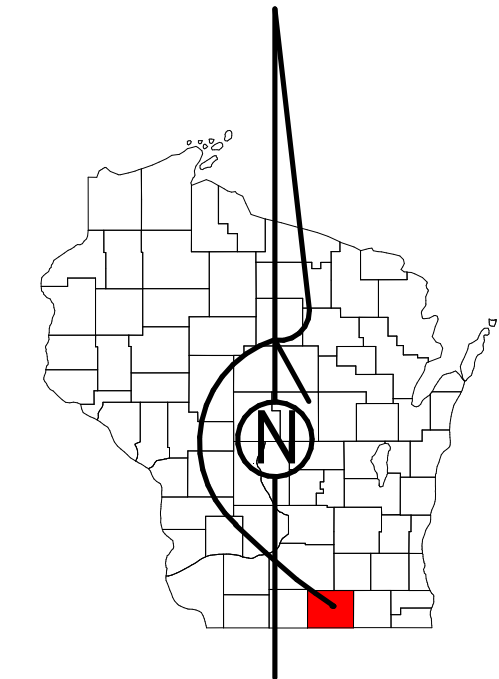

STATE OF WISCONSIN
COUNTY OF ROCK

PREPARED BY

REAL PROPERTY DESCRIPTION
DEPARTMENT

USING

ROCK COUNTY
GEOGRAPHIC INFORMATION SYSTEM

DUPLICATION OF THIS MAP PROHIBITED
WITHOUT THE WRITTEN CONSENT OF THE
REAL PROPERTY DESCRIPTION DEPARTMENT.

THIS MAP WAS PREPARED PURSUANT
TO SECTION 70.09 WIS. STAT.
USING PUBLIC RECORDS. IT IS NOT INTENDED
TO BE A SUBSTITUTE FOR AN
ACTUAL FIELD SURVEY
AND IS ADVISORY ONLY.

DISTANCES SHOWN ON THIS
MAP WERE PRODUCED BY
THE GIS SYSTEM AND ARE
FOR REFERENCE ONLY.
SEE DOCUMENT OF RECORD
FOR ACTUAL DISTANCE.

0 12.5 25 50 75 100
Feet

- Gap
- Overlap
- CSM
- CSMHYDRO
- CSMLOT
- CSMLOT HYDRO
- MFL
- dam
- easement
- hydro
- lots
- parcels
- parcelshydro
- roadw

See Pages

January 1, 2023

18 NWSW