

Property Division Map

City
of
Edgerton

T. 4 N. - R. 12 E.
Section 04 SWSE

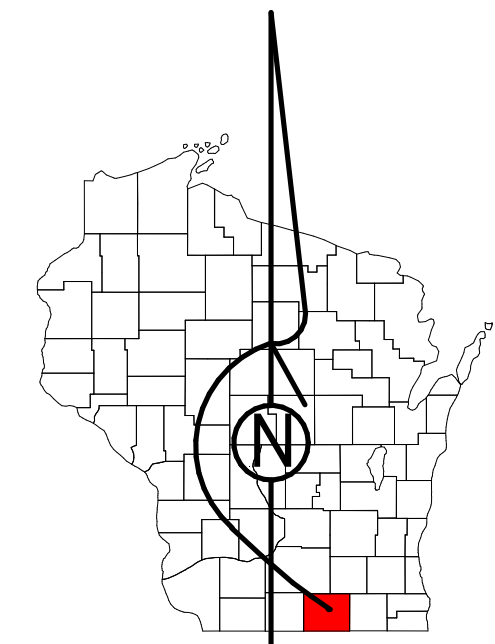

STATE OF WISCONSIN
COUNTY OF ROCK

PREPARED BY

REAL PROPERTY DESCRIPTION
DEPARTMENT

USING











ROCK COUNTY
GEOGRAPHIC INFORMATION SYSTEM

DUPLICATION OF THIS MAP PROHIBITED
WITHOUT THE WRITTEN CONSENT OF THE
REAL PROPERTY DESCRIPTION DEPARTMENT.

THIS MAP WAS PREPARED PURSUANT
TO SECTION 70.09 WIS. STATS.
USING PUBLIC RECORDS. IT IS NOT INTENDED
TO BE A SUBSTITUTE FOR AN
ACTUAL FIELD SURVEY
AND IS ADVISORY ONLY.

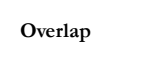
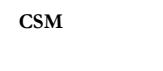
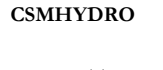
DISTANCES SHOWN ON THIS
MAP WERE PRODUCED BY
THE GIS SYSTEM AND ARE
FOR REFERENCE ONLY.
SEE DOCUMENT OF RECORD
FOR ACTUAL DISTANCE.

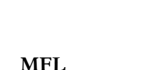
0 12.5 25 50 75 100
Feet

-  Gap
-  Overlap
-  CSM
-  CSMHYDRO
-  CSMLOT
-  CSMLOTHYDRO
-  dam
-  easement
-  hydro
-  lots
-  parcels
-  parcelshydro
-  roadrw

See Pages

January 1, 2023

04 SWSE

04 NWSE

09 NWNE

04 SE4W

04 SE5E

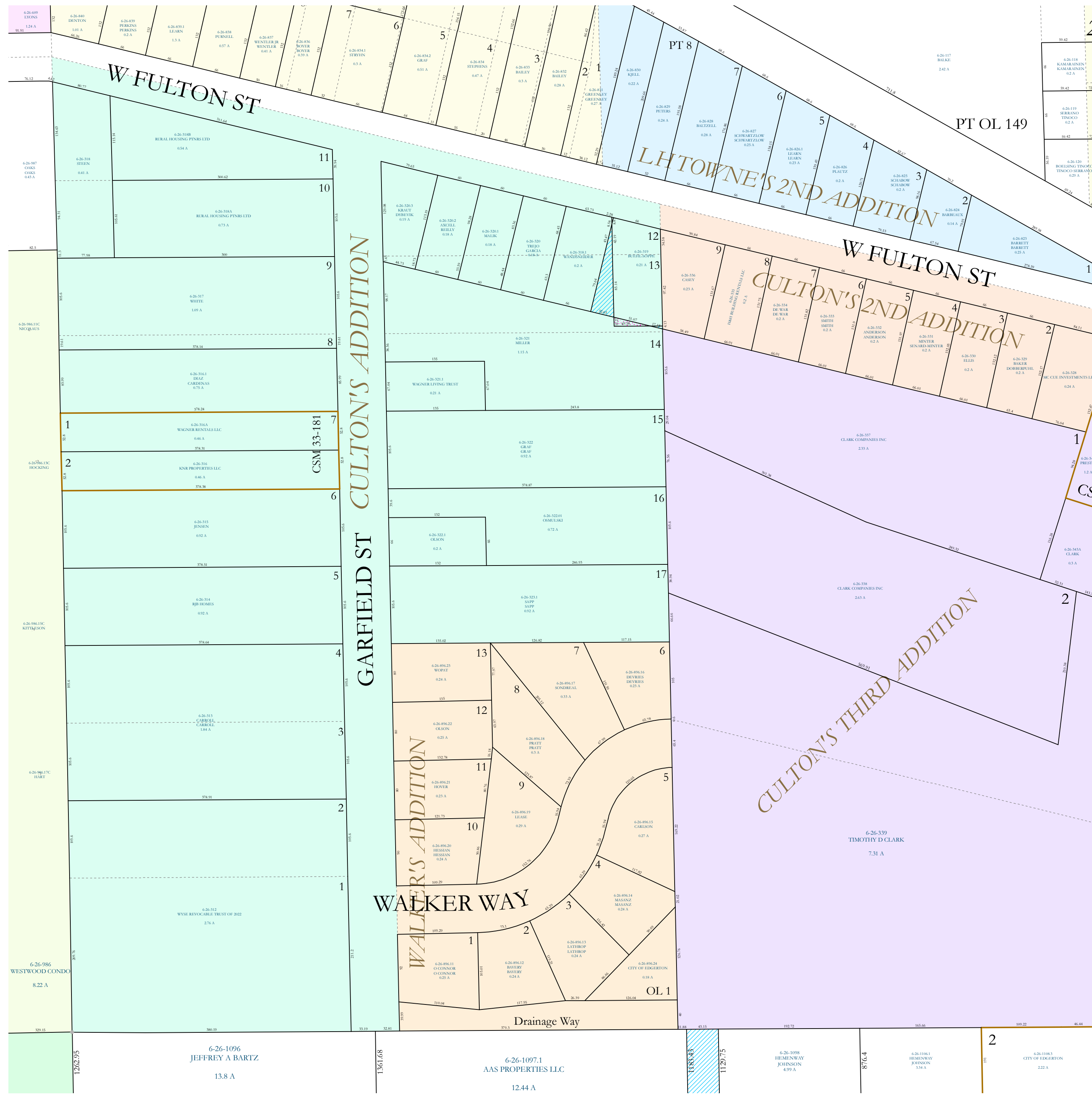

6-26-099 IVONS 1.24 A

6-26-040 BENTON 1.01 A

6-26-039 PERKINS PERKINS 0.2 A

6-26-031 LEAHY 1.5 A

6-26-038 PURNELL 0.57 A

6-26-037 BENTLEY BENTLEY 0.4 A

6-26-036 BOWER BOWER 0.39 A

6-26-034 STEVENS 0.3 A

6-26-032 GRAY 0.31 A

6-26-033 BULLOCK 0.3 A

6-26-032 BARLEY 0.29 A

6-26-030 KPHL 0.22 A

6-26-029 PETERSON 0.24 A

6-26-028 BALEZIEL 0.28 A

6-26-027 WURTZLOW WURTZLOW 0.23 A

6-26-026 LEARN LEARN 0.23 A

6-26-025 PLANTZ 0.2 A

6-26-024 BARRETT 0.14 A

6-26-023 BARRETT 0.23 A

6-26-022 BORLING TINGO BORLING TINGO 0.29 A

6-26-114 KAMMAMANN KAMMAMANN 0.2 A

6-26-119 TINGO TINGO 0.2 A

6-26-120 BORLING TINGO BORLING TINGO 0.29 A

6-26-087 OWAN OWAN 0.9 A

6-26-039 STEIN 0.41 A

6-26-038 BURAL HOUSING PTNS LTD 0.54 A

6-26-038 BURAL HOUSING PTNS LTD 0.73 A

6-26-037 WHITE 1.09 A

6-26-036 CARDENAS 0.75 A

6-26-035 WAGNER TRUST 0.21 A

6-26-034 WAGNER TRUST 0.21 A

6-26-033 WAGNER TRUST 0.21 A

6-26-032 WAGNER TRUST 0.21 A

6-26-031 WAGNER TRUST 0.21 A

6-26-030 WAGNER TRUST 0.21 A

6-26-029 WAGNER TRUST 0.21 A

6-26-028 WAGNER TRUST 0.21 A

6-26-027 WAGNER TRUST 0.21 A

6-26-026 WAGNER TRUST 0.21 A

6-26-025 WAGNER TRUST 0.21 A

6-26-024 WAGNER TRUST 0.21 A

6-26-023 WAGNER TRUST 0.21 A

6-26-022 WAGNER TRUST 0.21 A

6-26-021 WAGNER TRUST 0.21 A

6-26-020 WAGNER TRUST 0.21 A

6-26-019 WAGNER TRUST 0.21 A

6-26-018 WAGNER TRUST 0.21 A

6-26-017 WAGNER TRUST 0.21 A

6-26-016 WAGNER TRUST 0.21 A

6-26-015 WAGNER TRUST 0.21 A

6-26-014 WAGNER TRUST 0.21 A

6-26-013 WAGNER TRUST 0.21 A

6-26-012 WAGNER TRUST 0.21 A

6-26-011 WAGNER TRUST 0.21 A

6-26-010 WAGNER TRUST 0.21 A

6-26-009 WAGNER TRUST 0.21 A

6-26-008 WAGNER TRUST 0.21 A

6-26-007 WAGNER TRUST 0.21 A

6-26-006 WAGNER TRUST 0.21 A

6-26-005 WAGNER TRUST 0.21 A

6-26-004 WAGNER TRUST 0.21 A

6-26-003 WAGNER TRUST 0.21 A

6-26-002 WAGNER TRUST 0.21 A

6-26-001 WAGNER TRUST 0.21 A

6-26-337 CLARK COMPANIES INC 231 A

6-26-337 CLARK COMPANIES INC 255 A

6-26-337 CLARK COMPANIES INC 255 A

6-26-339 TIMOTHY D CLARK 7.31 A

6-26-096 WESTWOOD CONDO 8.22 A

6-26-912 WYBE REVOCABLE TRUST OF 2022 2.76 A

6-26-1096 JEFFREY A BARTZ 13.8 A

6-26-1097.1 AAS PROPERTIES LLC 12.44 A

6-26-1098 HEDENWAY JOHNSON 4.99 A

6-26-108.1 JOHNSON 3.34 A

6-26-108.3 CITY OF EDGERTON 2.23 A