

Of a Survey on Section 25 T. 1 R. 14 E. of the 4 P. M. in CLINTON Township
Rock County, Wisconsin, made OCT. the 1980

I hereby certify that the following is a correct record of said survey as made by me.

COUNTY BUILDING
CITY OF JANESVILLE



County Surveyor.

S 1/4 COR SEC 25 WI.

DUG 6' DEEP AND FOUND OLD E/W FENCE LINE. SET ALUM MON ON LINE WITH THE SE AND SW CORNER OF SEC 25 AT SINGLE PROPORTIONATE MEASUREMENT. THIS IS IN HARMONY WITH THE OLD E/W FENCE LINE BUT NOT WITH PRESENT N/S FENCE LINE.

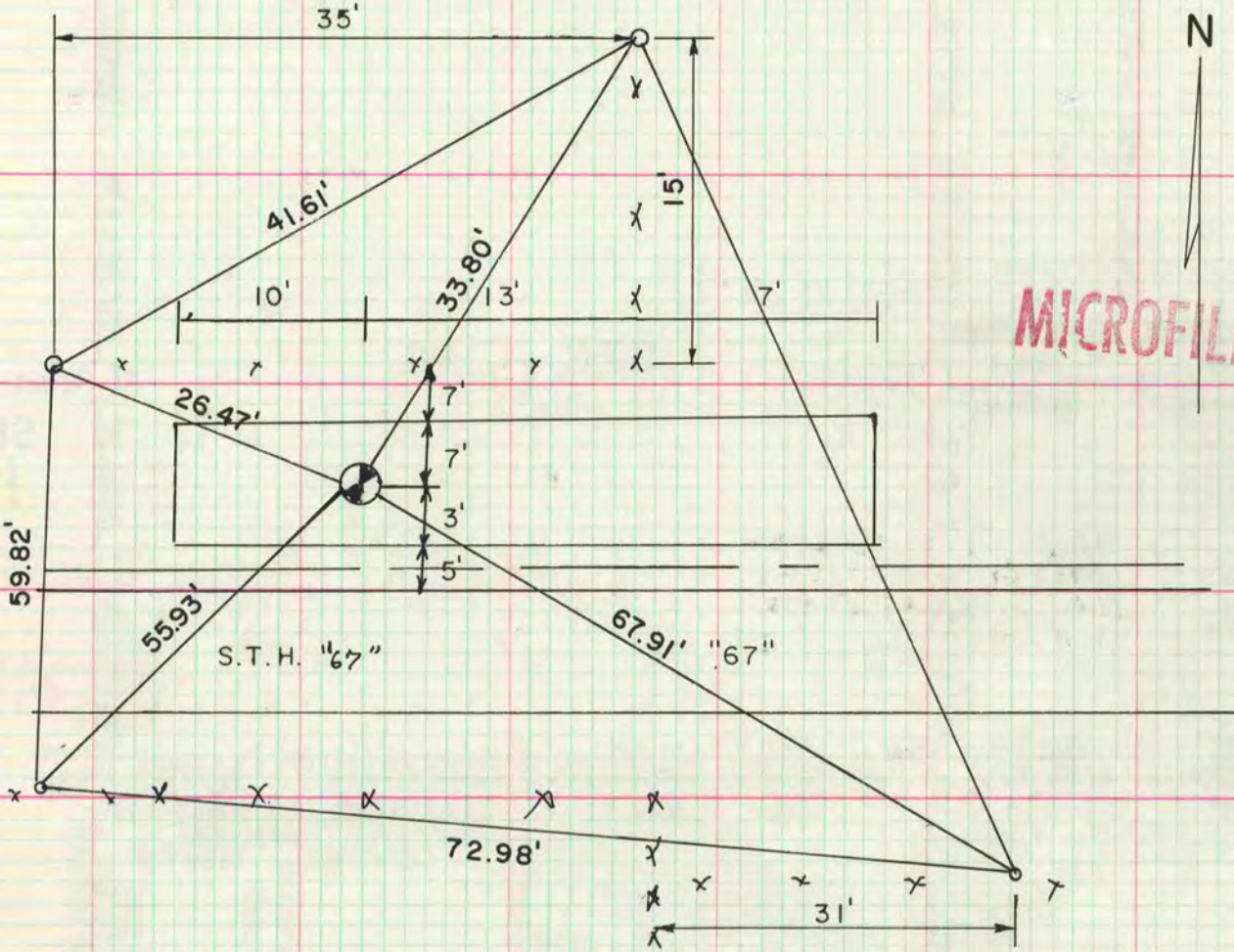

E 1/4 COR SEC 25

DUG AND FOUND NOTHING. SET ALUM MON ON LINE WITH THE SE & NE CORNERS OF SEC 25 AT SINGLE PROPORTIONATE DISTANCE.

