

VOL. 6 PLAT AND RECORD

48

Of a Survey on Section 8, 9 T 1 R 12 E. of the 4 P. M. in Beloit Township  
Rock County, Wisconsin, made July 19 80

I hereby certify that the following is a correct record of said survey as made by me.



COUNTY BUILDING  
CITY OF JANESVILLE

S. 1/4 Cor. of Sec. 8  
of Sec. 8  
Fd. Conc. Mon.

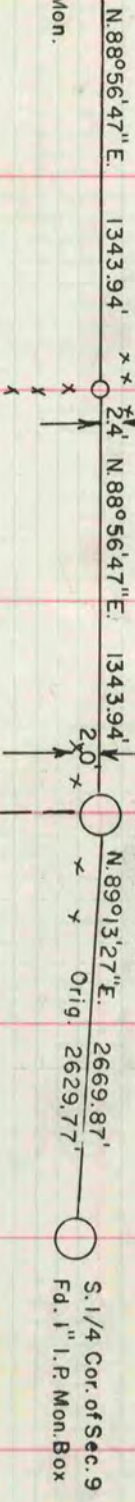

Orig. 2644.13'  
Locke 1864 2673.66'  
N. 88°56'47\"/>

SEC 8

SEC 9

DUG & FOUND CONCRETE MONUMENT WITH FOASS CAP. TOP PORTION BROKE OFF. SET 15\"/>

DUG AND FOUND STONES OF RECORD BUT DID NOT FIND STAKE. SET 7\"/>

DUG AND FOUND NOTHING. SET ALUM ON LINE WITH THE S 1/4 CORNER OF SECTION 8 AND THE S 1/16 th CORNER OF THE SE 1/4 OF SECTION 8 AT SINGLE PROPORTIONATE DISTANCE.

S.E. Cor. of Sec. 8

S. 1/16 of SE 1/4 of Sec. 8

S. 1/4 Cor. of Sec. 8

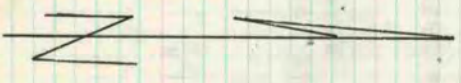

MICROFILMED