

PLAT AND RECORD

VOL. 6

~~568~~
45

Of a Survey on Section ^{1,2} 11, 12 T 2 R 14 E. of the 4 P.M. in BRADFORD Township
Rock County, Wisconsin, made MAY 30 1980

I hereby certify that the following is a correct record of said survey as made

COUNTY BUILDING
CITY OF JANESVILLE

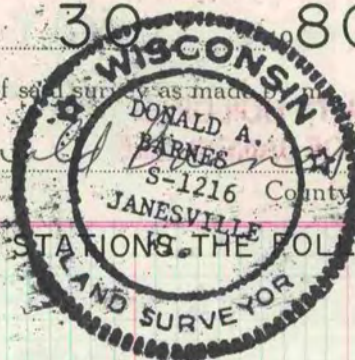

STATE HWY. DEPT. REVISED COORDINATES FOR CONTROL STATIONS THE FOLLOWING
ARE REVISED COORDINATES FOR SECTION CORNERS.

SEE VOL 6 PG 31

	N/S	E/W
E 1/4 COR SEC I	242,957.78'	2,329,113.23'
W 1/4 COR SEC I	243,039.49'	2,323,803.05'
SE COR SEC I	240,320.67'	2,329,142.13'
SW COR SEC I	240,397.04'	2,323,846.96'
S 1/4 COR SEC I	240,337.04'	2,326,494.54'
N 1/4 COR SEC II	240,460.66'	2,321,203.29'
NW COR SEC II	240,524.27'	2,318,559.63'
W 1/4 COR SEC II	237,881.90'	2,318,626.71'
E 1/4 COR SEC II	237,750.38'	2,323,916.93'
SE COR SEC II	235,105.58'	2,323,987.00'
E 1/4 COR SEC 12	237,660.20'	2,329,174.89'

MICROFILMED

MICROFILMED