

12 VOL 6

PLAT AND RECORD

Of a Survey on Section **16** T **4** R **14** E. of the 4 P. M. in **LIMA** Township
Rock County, Wisconsin, made **DEC** the **10** 19**79**

I hereby certify that the following is a correct record of said survey made by me
COUNTY BUILDING
CITY OF JANESVILLE



SI/4 COR SEC 16

DID NOT DIG FOR THE COR, BECAUSE THE AREA WAS DISTURBED. LOCK (1864) SHOWS THE SI/4 CORNER IS NOT ON A STRAIGHT LINE BETWEEN THE SE & SW CORNER. I SET AN ALUM MON 15" DEEP. I CONTROLLED THE E/W DISTANCE BY PRORATING LOCK'S DISTANCE FROM THE SE TO SW CORNER OF SEC 16. THE N/S DISTANCE IS CONTROLLED BY PRORATING LOCK'S DISTANCE FROM THE CENTER TO THE SI/4 CORNER WITH THE TOTAL MEASURED DISTANCE & LOCK'S TOTAL DISTANCE FROM THE E1/4 TO THE W1/4 CORNER AND THE SE TO THE SW CORNER OF SEC 16.

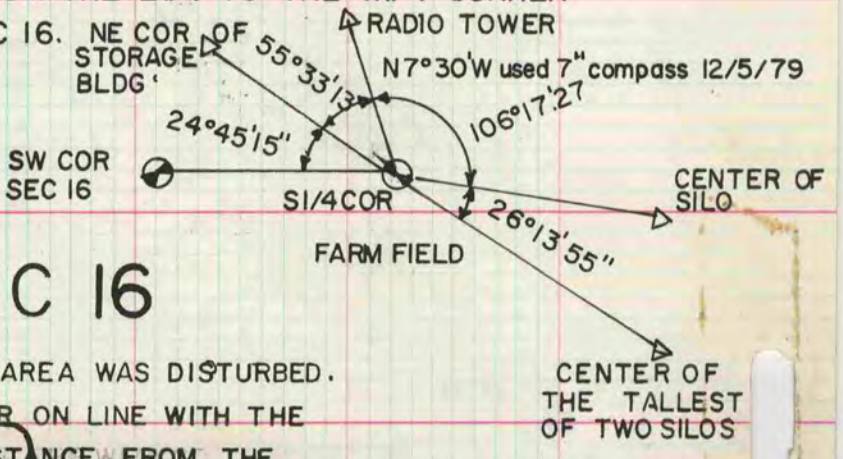

CENTER OF SEC 16

DID NOT DIG FOR THE CORNER BECAUSE THE AREA WAS DISTURBED. SET AN ALUM MON 15" DEEP. SET THE CORNER ON LINE WITH THE E1/4 CORNER & 1/16th CORNER & EQUAL DISTANCE FROM THE E1/4 TO THE W1/4 CORNER. THIS IS IN HARMONY WITH LOCKS 1864 SURVEY & THE STATE LAW FOR SUBDIVING A SECTION THEN.

MICROFILMED

E 1/4 COR SEC 16

SET AN ALUM MON. FD PK ON TOP OF 1" X 6" IP. UNDER THAT A BENT 1/2" X 24" IP @ 2 HH

N1/4 COR SEC 16

SET 1" X 8" IP. USED LOCKS DISTANCE TO THE CENTER OF PRORATION. THIS IS IN HARMONY WITH OCCUPATION. ALSO USED THE ORIG GOV DIS AS SHOWN ON PG 556 VOL 5 TO CONTROL THE E/W DIRECTION. THIS IS IN HARMONY WITH THE ORIG. GOV. FIELD NOTES

N1/16th COR OF THE SE 1/4

DUG & 0.5 DEEP 4 HH & OLD FENCE POST ON EAST SIDE. SET G1 MON

