

PLAT AND RECORD

505
V-4

COUNTY BUILDING
CITY OF JANESVILLE

COUNTY BUILDING
CITY OF JANESVILLE

Of a Survey on Section 11 T 2N R 14 E. of the 4 P. M. in BRADFORD Township

Rock County, Wisconsin, made JUNE the 2 1971

I hereby certify that the following is a correct record of said survey as made by me.

MICROFILMED

Hugh J. Lee
County Surveyor.

County Surveyor.

THE GEO. D. SARGENT COMPANY, ST. LOUIS

SCHARINE

HWY 14

ROCK RD.

CARVER

RD.

THRESHER

11

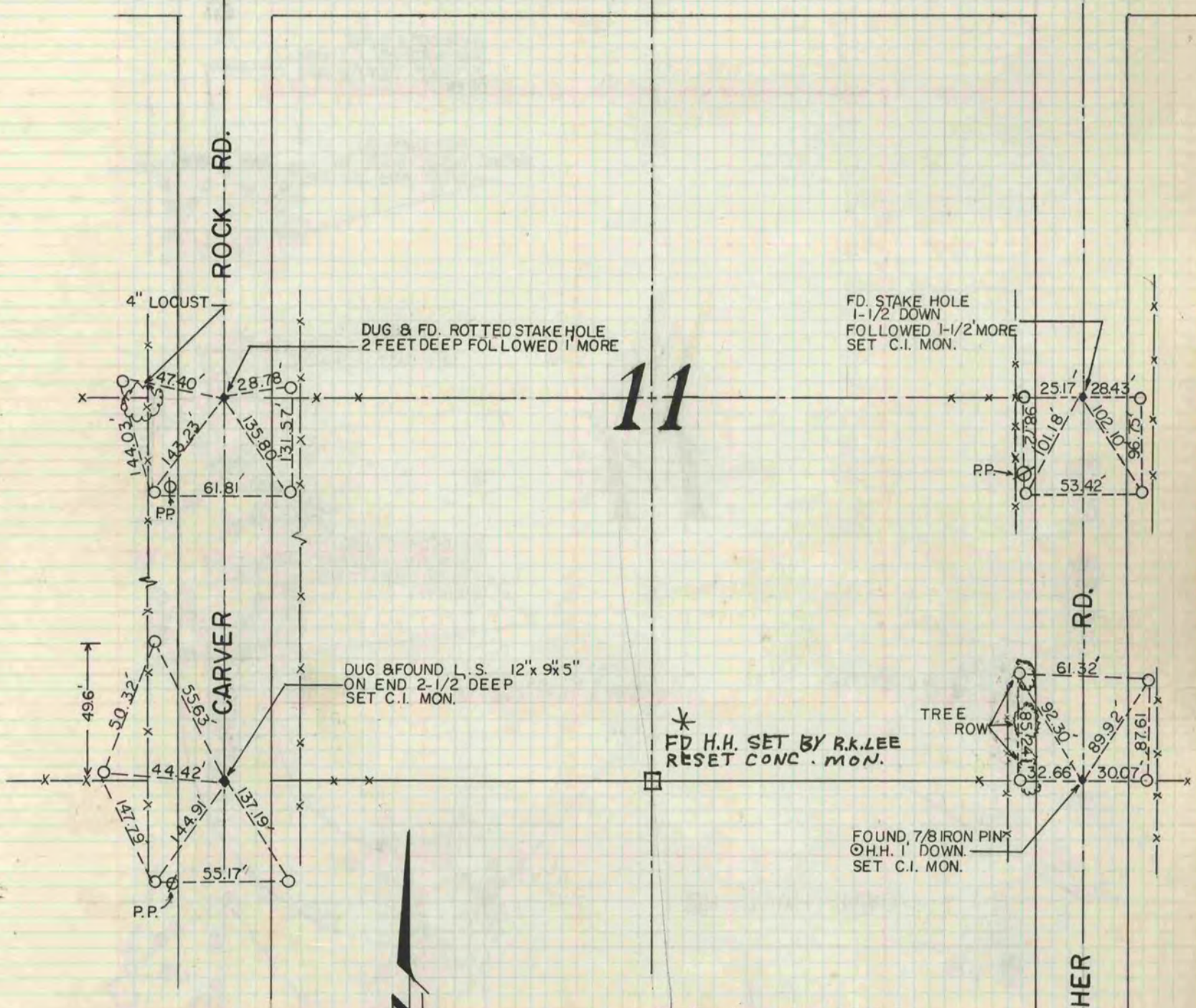

DUG & FD. ROTTED STAKE HOLE
2 FEET DEEP FOLLOWED 1' MORE

FD. STAKE HOLE
1-1/2' DOWN
FOLLOWED 1-1/2' MORE
SET C.I. MON.

DUG & FOUND L.S. 12" x 9" x 5"
ON END 2-1/2' DEEP
SET C.I. MON.

* FD H.H. SET BY R.K. LEE
RESET CONC. MON.

FOUND 7/8 IRON PIN*
O.H.H. 1' DOWN.
SET C.I. MON.

NOTE: O = 1" x 24" IRON PIPE REF. MON.

J.M.S
J.E.L

* COPIED FROM BELOIT REC
12/11/75 DAB