

PLAT AND RECORD

COUNTY BUILDING
CITY OF JANESVILLE

121
V-4

Of a Survey on Section 23-24-25-26T 2 N R 11 E. of the 4 P. M. in PLYMOUTH Township

Rock County, Wisconsin, made AUGUST the 1st 1961

I hereby certify that the following is a correct record of said survey as made by me.

MICROFILMED

R. Thom

County Surveyor.

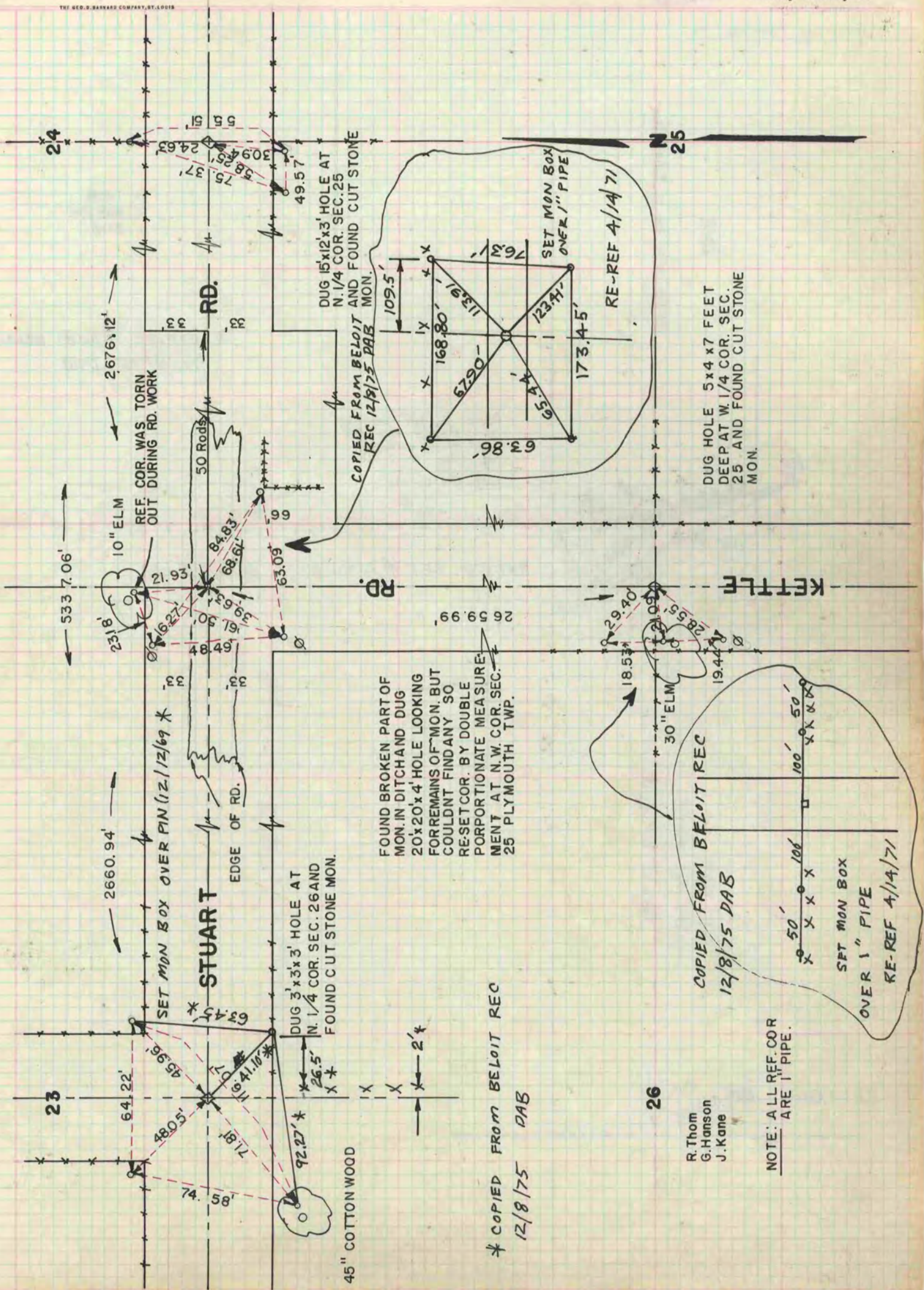

FOUND BROKEN PART OF
MON. IN DITCH AND DUG
20x20x4' HOLE LOOKING
FOR REMAINS OF MON. BUT
COULDN'T FIND ANY SO
RE-SET COR. BY DOUBLE
PROPORTIONATE MEASURE-
MENT AT N.W. COR. SEC.
25 PLYMOUTH TWP.

* COPIED FROM BELOIT REC
12/8/75 DAB

R. Thom
G. Hanson
J. Kane

NOTE: ALL REF. COR
ARE 1" PIPE.

COPIED FROM BELOIT REC
12/8/75 DAB

50' x 50' x 50'
SET MON BOX
OVER 1" PIPE
RE-REF 4/14/71

DUG HOLE 5x4x7 FEET
DEEP AT W. 1/4 COR. SEC.
25 AND FOUND CUT STONE
MON.

DUG 15x12x3' HOLE AT
N. 1/4 COR. SEC. 25
AND FOUND CUT STONE
MON.

COPIED FROM BELOIT
REC 12/8/75 DAB

SET MON BOX
OVER 1" PIPE
RE-REF 4/14/71