

PLAT AND RECORD

COUNTY BUILDING
CITY OF JANESVILLE

Of a Survey on Section 10 T 4 R 13 E. of the 4 P. M. in MILTON Township

Rock County, Wisconsin, made APRIL the 8 th 1964

I hereby certify that the following is a correct record of said survey as made by me.

R. B. Balthasar

County Surveyor.

MICROFILMED

FOUND 6" x 6"
CUT STONE WITH
TOP BROKEN OFF
E. 1/4 CORNER SEC. 10
4-8-64

H. COMBS
H. LEE
T. KERWIN
R. KILDAY

Set RR. spike in
E. of pavement
1-30-69

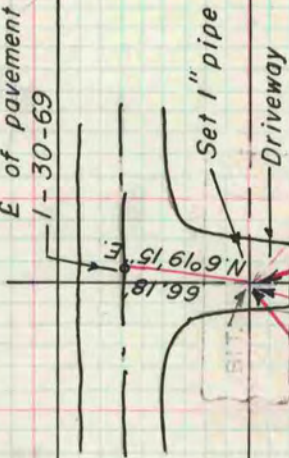

THE NEW ROADWAY
WILL BE NORTH OF
OLD ROAD.

SEE PG. 7 BK. 129

DUG LARGE HOLE 15' x 7' x 3'
FOUND NOTHING.
AT 1/4 1/4 CORNER.

See page 389

All Bearings are True Bearings

C.T.H. "N"

1317'

1317'

VOGEL ROAD

DUG LARGE HOLE 10' x 10' x 3'
FOUND NOTHING AT CENTER SEC. 10

40 d SPIKE
IN BRACE
POST.
CEMETERY