

MICROFILMED

# PLAT AND RECORD

Of a Survey on Section 10 T 4 R 12 E. of the 4 P. M. in Fulton Township

Rock County, Wisconsin, made December the 26<sup>th</sup> 1859

I hereby certify that the following is a correct record of said survey as made by me.

COUNTY BUILDING  
CITY OF JANESVILLE

(Signed) Edward Roger  
R.H.B. County Surveyor.

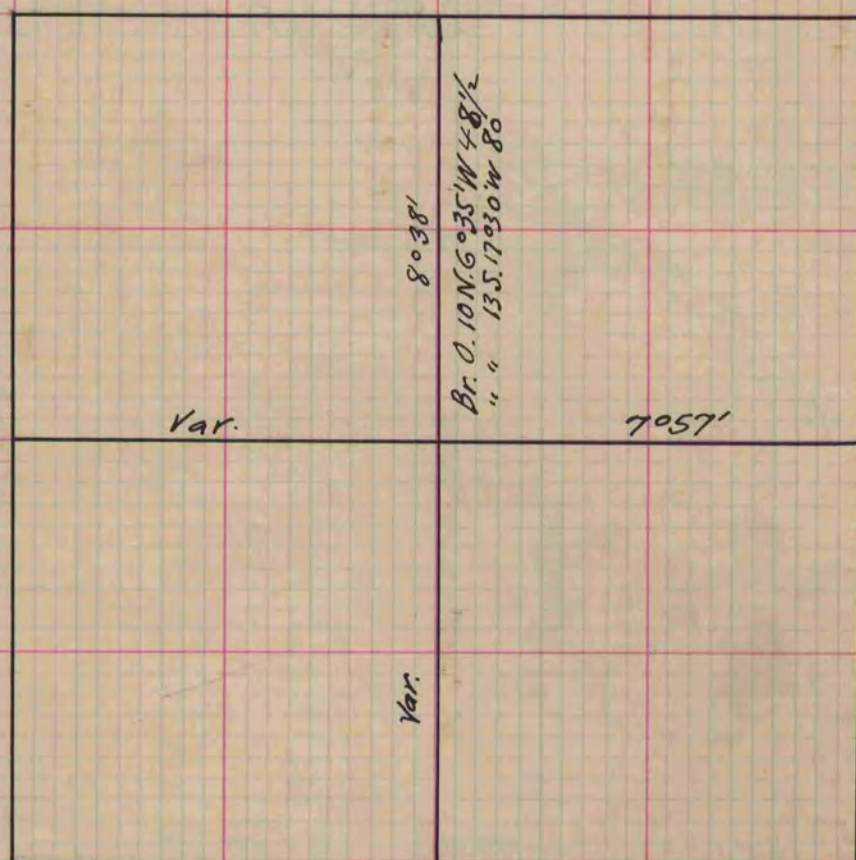

*Copied from Page 131 Vol. 1. Original County Surveyors Record*