

PLAT AND RECORD

MICROFILMED

Of a Survey on Section 21 T / R 12 E. of the 4 P. M. in Beloit Township
 Rock County, Wisconsin, made the _____ 19____

I hereby certify that the following is a correct record of said survey as made by me.

COUNTY BUILDING
CITY OF JANESVILLE

(Signed) Edward Ruger
P.H.B.

County Surveyor.

For Dexter, Farr & Dresser

Distances given in chains
Variations Marked on the lines

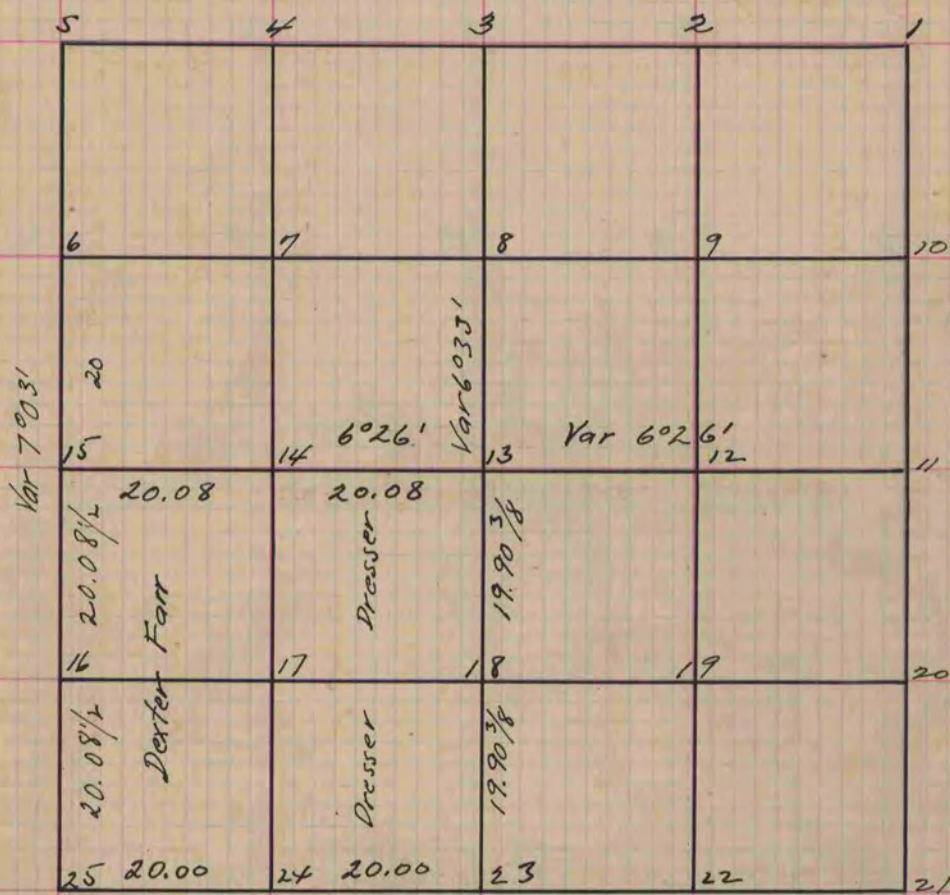

- At Fig. 3 Surrounded 1/4 post by 4 Hard Head Stones
- " " 11 " " " " " " " "
- " " 13 " " " " " " " "
- " " 14 " " " " " " " "
- " " 15 " " " " " " " "
- " " 16 " " " " " " " "
- " " " Burr Oak 2 S 7°03' W 54 1/2 Var 7°03'
- " " " " " 8 N 2°18' W 144 2/3 Var 7°03'
- " " 17 Surrounded 1/6 post by 3 Hard Head Stones
- " " 18 " " " " " " " "
- " " 23 " " " " " " " "
- " " 24 " " " " " " " "
- " " 25 " Sector " " " Lime Stones
- " " " took new witness Trees
- " " " Burr Oak 10 S 35°50' E 196
- " " " Black Oak 5 S 50°43' W. 155 1/3
- " " " Hickory 2 N 64°31' W. 171 1/3 Var 6°50'

Copied from Page 105 Vol. 1. Original County Surveyors Record