

MICROFILMED

PLAT AND RECORD

Of a Survey on Section 14 T 2 R 10 E. of the 4 P. M. in Spring Valley Township

Rock County, Wisconsin, made March the 25th & 26th 1857

I hereby certify that the following is a correct record of said survey as made by me.

COUNTY BUILDING
CITY OF JANESVILLE

(Signed) Joseph Church
R.H.D.

County Surveyor:

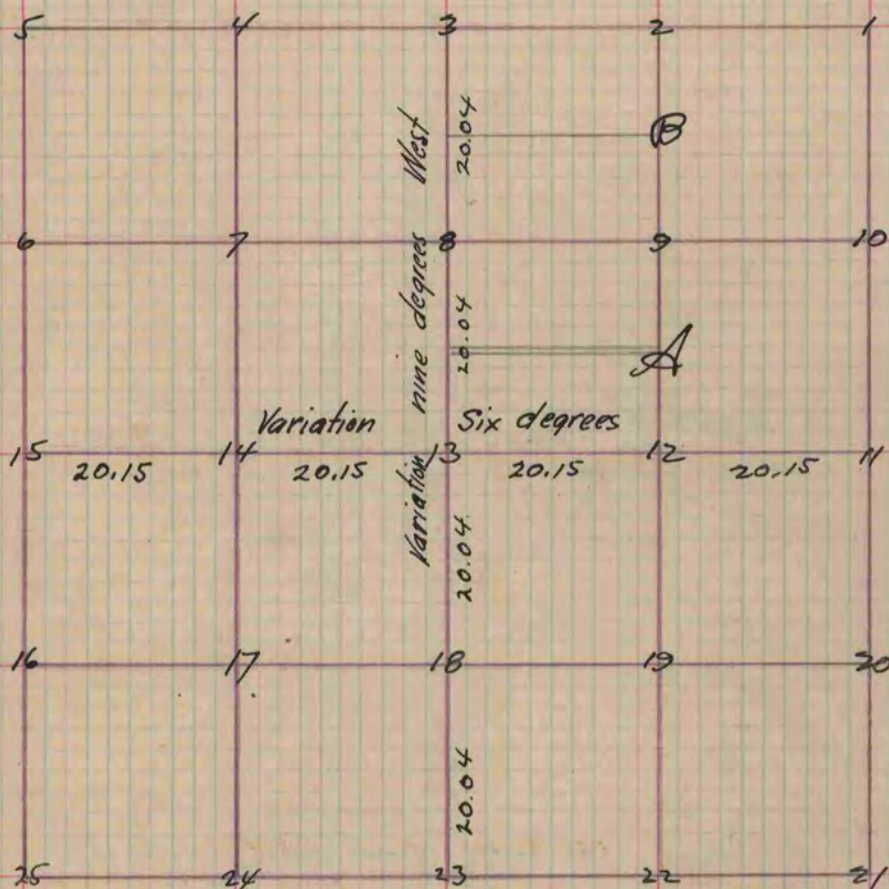

- Fig 13 Br 0.20 S. 10 1/2 E 73
- 14 N 88 E 74
- " 12 28 S 60 W. 59 1/2
- 2 Bl.O. 14 N 25 1/4 E. 78
- 10 S 41 1/2 E. 100
- 9 W.O. 20 N 1 1/2 E 25
- 20 S 49 1/2 E 51 3/4

Letter A W.O. 12 S 78 E 89

" " 10 N 20 W 37

Variation of the Compass nine degrees

Copied from Page 69 Vol. One Original County Surveyors Record