

PLAT AND RECORD

Of a Survey on Section 28 T 2 R 11 E. of the 4 P. M. in Plymouth Township

Rock County, Wisconsin, made May the 25th & 26th 1855

I hereby certify that the following is a correct record of said survey as made by me.

COUNTY BUILDING
CITY OF JANESVILLE

(Signed) Joseph Church
R.H.B.

County Surveyor.

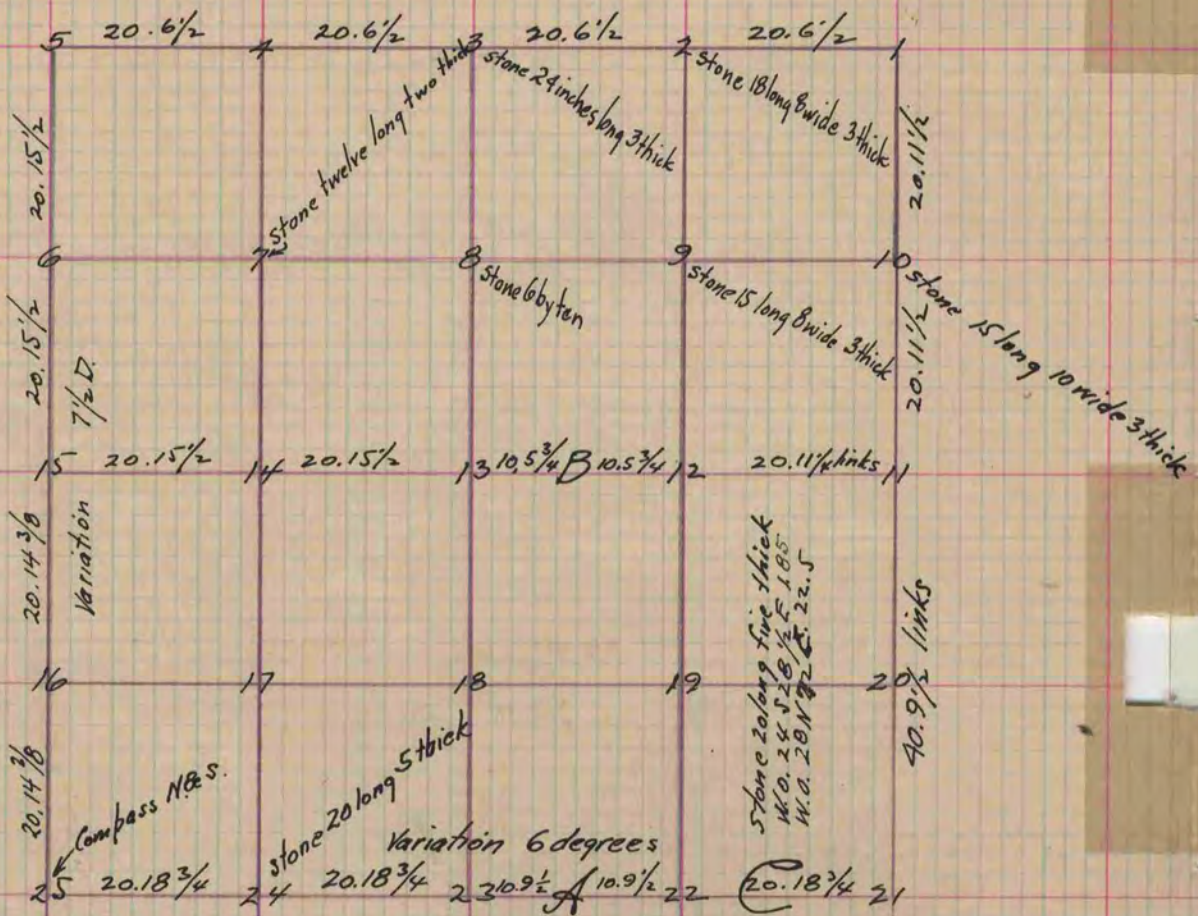

- Fig. 25 Stone 24 inch long 8 wide 4 inch thick School house S. 6 1/2° E. 239 lin
S.E. corner of Jake Fishers house N. 47 3/4 W. 151
- " 21 Stone 12 inches long 3 inches thick
- " 15 Stone 18 long four inches thick 8 inches wide S. Corner house N. 15 1/2 W 566
Locust tree N. 58 W. 42 links
- " 6 Stone 15 inch long ten wide 3 thick
- " 4 Stone 20 inch long ten wide 3 thick
Black O. N 54 E 203 links Black Oak N. 54 W. 220 links
- " 5 Stone 18 long 6 inch thick
- " 1 Stone 15 long 8 wide 4" thick
- " 13 Stone 15 long 8 wide 8 thick
- " 12 Stone 14 long 8 wide 6 thick
- " 11 Stone 18 long 8 wide
- " 23 Stone 20 long 5 inches thick Lewis Smitzs house NW corner S. 35 3/4 E 257 3/4 links
Locust tree Six inches N 28 1/2 W. 44 1/2
- A Stone 20 long 6 inches thick
- B. Stone 14 long 8 inches wide 3 inch thick
- Fig 8 Stone ten inches long 6 inches wide
- " 9 Stone 6 by ten inches
- " 24 Stone 20 inches long 5 inches thick

Copied from Page 39 Vol. 1. Original County Surveyors Record