

MICROFILMED PLAT AND RECORD

Of a Survey on Section 28 T 2 R 10 E. of the 4 P. M. in Spring Valley Township
Rock County, Wisconsin, made April the 8th & 9th 1855

I hereby certify that the following is a correct record of said survey as made by me.

COUNTY BUILDING
CITY OF JANESVILLE

(Signed) Joseph Church
R.H.B. County Surveyor.

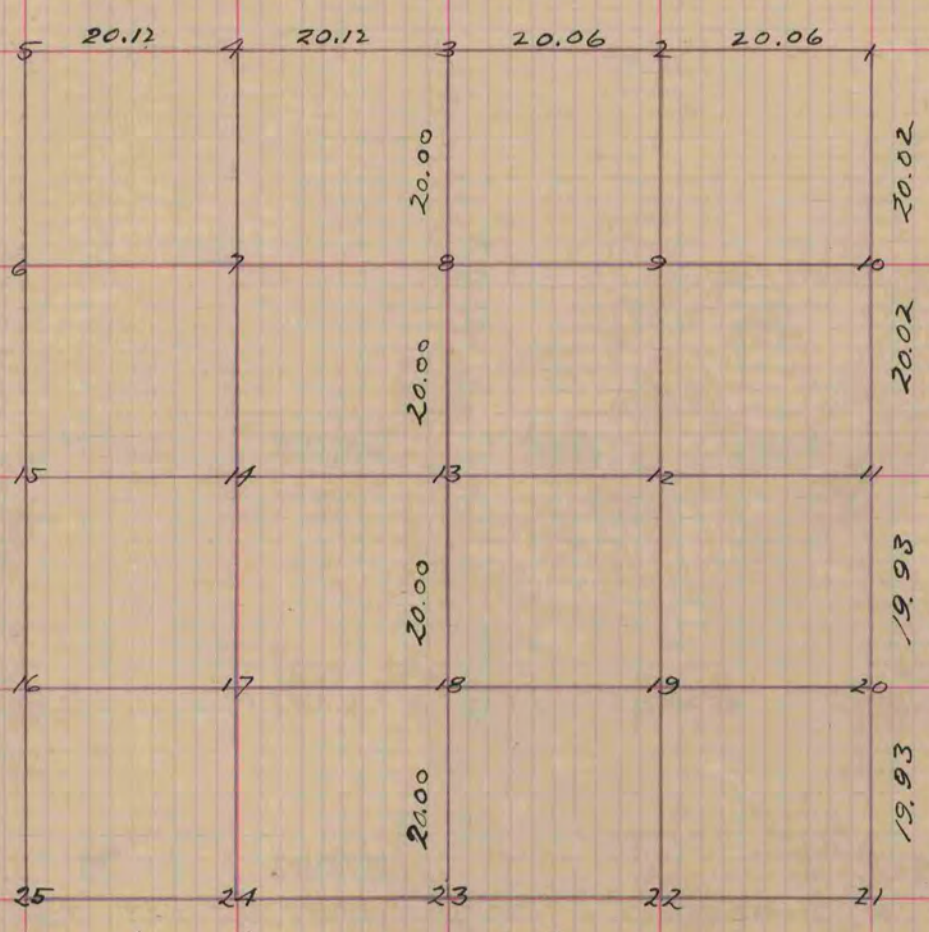

Fig 13 represents the centre of the Sec.
 Black O B S 89 1/2 E 43 links
 Black O B S 49 1/2 W. 40 "
 " 12 Bor O S 44 W 18 "
 " 22 W. O. 24 N 48 1/2 W. 96 "
 " 20 Bor O 16 S 28 1/2 W. 112 "
 " 24 " " N 59 1/2 E, 24 "
 " 8 " " 16 S 55 E 29 "

Copied from Page 33 Vol. 1. County Surveyors Record