

PLAT AND RECORD

Of a Survey on Section 29-32 T 4 R 11 E. of the 4 P. M. in PORTER Township

Rock County, Wisconsin, made JULY the 25 1960

I hereby certify that the following is a correct record of said survey as made by me.

COUNTY BUILDING
IN CITY OF БЕЛОИТ

Russell E. Emery
County Surveyor.

THE GEO. D. BARNARD COMPANY, ST. LOUIS



R. THOM
G. HANSON
J. KANE

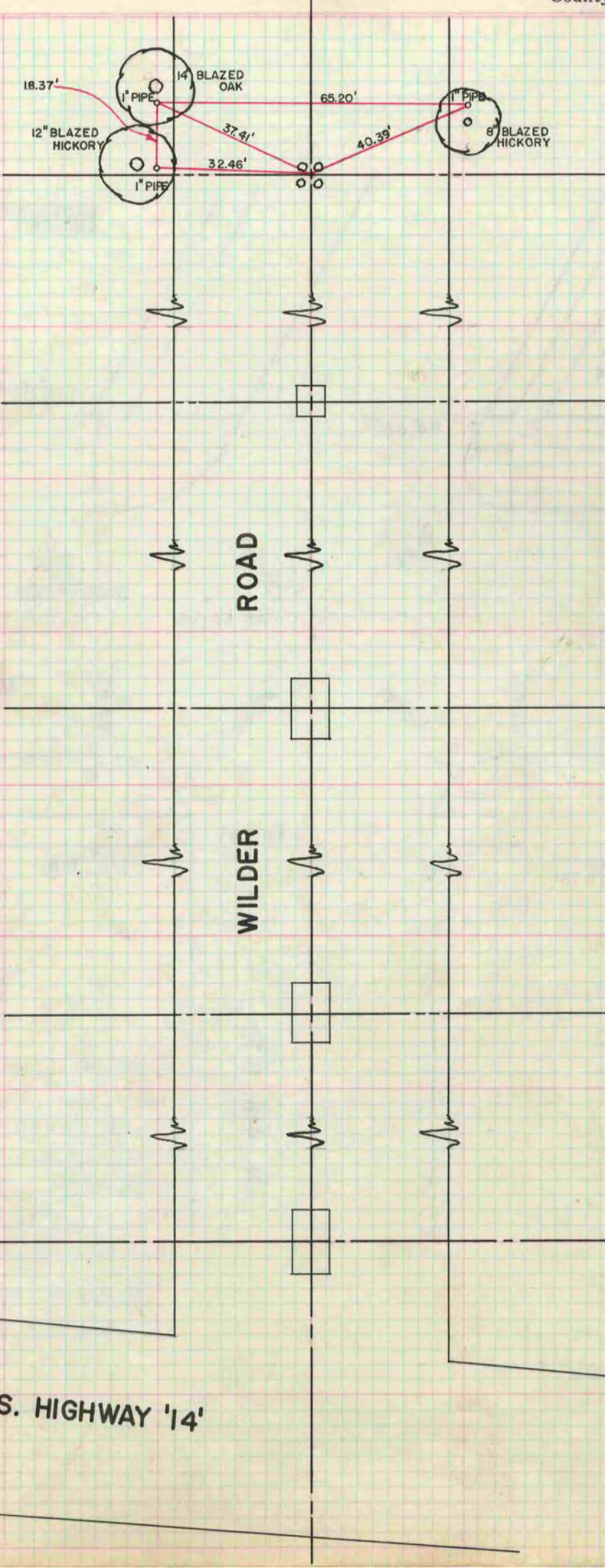

FOUND WOODEN STAKE SURROUNDED BY FOUR HARD HEAD STONES AT THE N. 1/4 COR. SEC. 29-4-11

DUG HOLE 5X5X2.5' AT THE NORTHWEST COR. OF THE S.W. 1/4 OF THE N.E. 1/4 OF SEC. 29-4-11 FOUND NOTHING

DUG HOLE 8X10X4' AT THE SOUTHWEST COR. OF THE NW 1/4 OF THE SE. 1/4 OF SEC. 29-4-11 FOUND NOTHING

DUG HOLE 8X10X4' AT THE NORTHWEST COR. OF THE S.W. 1/4 OF THE N.E. 1/4 OF SEC. 32-4-11 FOUND NOTHING

DUG HOLE 8X10X4' AT THE CENTER OF SECTION 32-4-11 FOUND NOTHING

U.S. HIGHWAY '14'