

PLAT AND RECORD

79

Of a Survey on Section 16 T 3 R 11 E. of the 4 P. M. in Centre Township

Rock County, Wisconsin, made May the 28th 1858

I hereby certify that the following is a correct record of said survey as made by me.

COUNTY BUILDING
IN CITY OF BELOIT

(Signed) Joseph Church
JMS

County Surveyor.

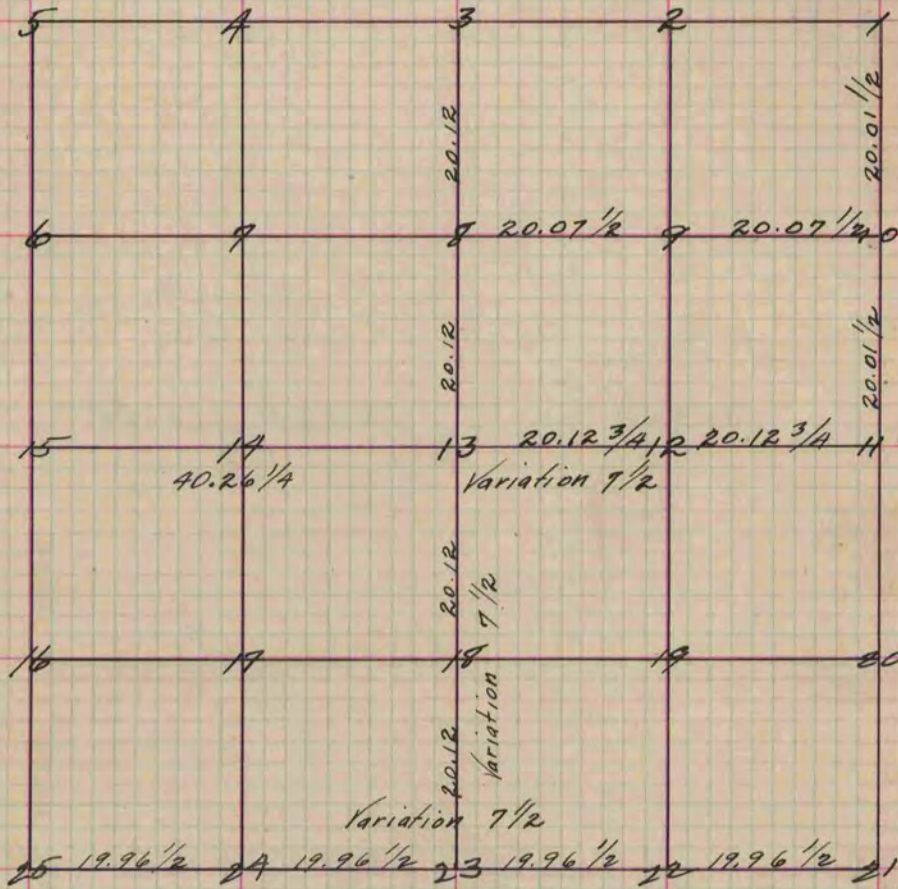

Fig. 13 B1.0.10 S. 41 W. 163

Br. O. 4 N. 35 W. 142 1/2 Stone

" 12 Stone no bearings on the prairie.

" 18 Stone " " " "

" 8 B1.0.4 S. 85 1/2 E. 49.

" " 4 S. 53 E. 79 1/2 Stone

" 11 Old trees gone took new ones. Br. O. 8 S. 81 E. 64 1/2

" 3 Old trees gone " " " W. O. 6 N. 32 1/2 E. 12

" " 18 N. 71 E. 170

" " 20 N. 42 1/2 W. 181

" 10 B1.0.12 N. 89 1/2 W. 12 Stone

" " 14 S. 46 E. 25

" 9 " " 3 S. 21 W. 41. W. O. 2 S. 48 W. 14 1/2 Stone

Copied from Page 80 Vol. 1 Original County Surveyors Record.