

PLAT AND RECORD

Of a Survey on Section 15 T 2 R 10 E. of the 4 P. M. in Spring Valley Township
 Rock County, Wisconsin, made March the 27th 1857

I hereby certify that the following is a correct record of said survey as made by me.

COUNTY BUILDING
 IN CITY OF BELOIT

(Signed) Joseph Church
JAC

County Surveyor.

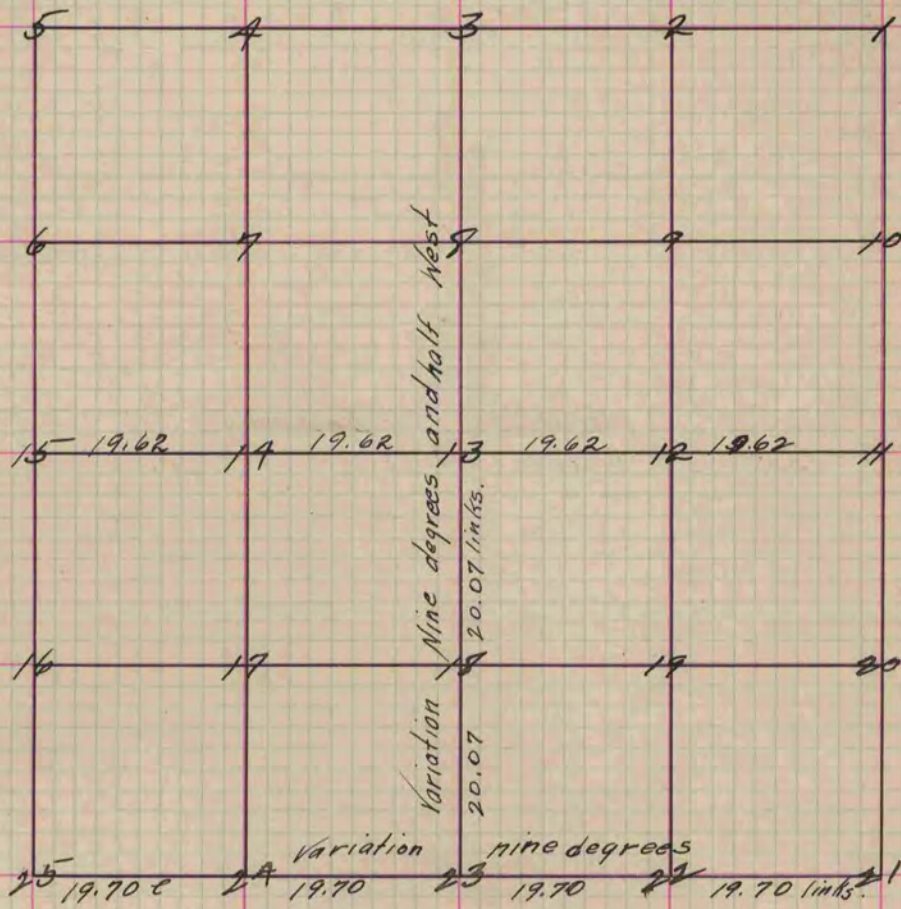

Fig. 13 Br. O. 14 S. $44\frac{1}{2}$ W. 29 links.

" 13 W. O. 24 N. $11\frac{1}{4}$ E. 34 "

" 14 W. O. 16 N. 62 E. 16 "

Variation on the Compass of nine degrees.

Fig. 23 the Government trees are not to be found,
 and made corner by running the South line, and,
 placing the stake in the Centre.

Copied from Page 70 Vol. 1. Original County Surveyor's Record.