

37  
 A record and plat of a survey made on Sec eight town  
 four range ten east

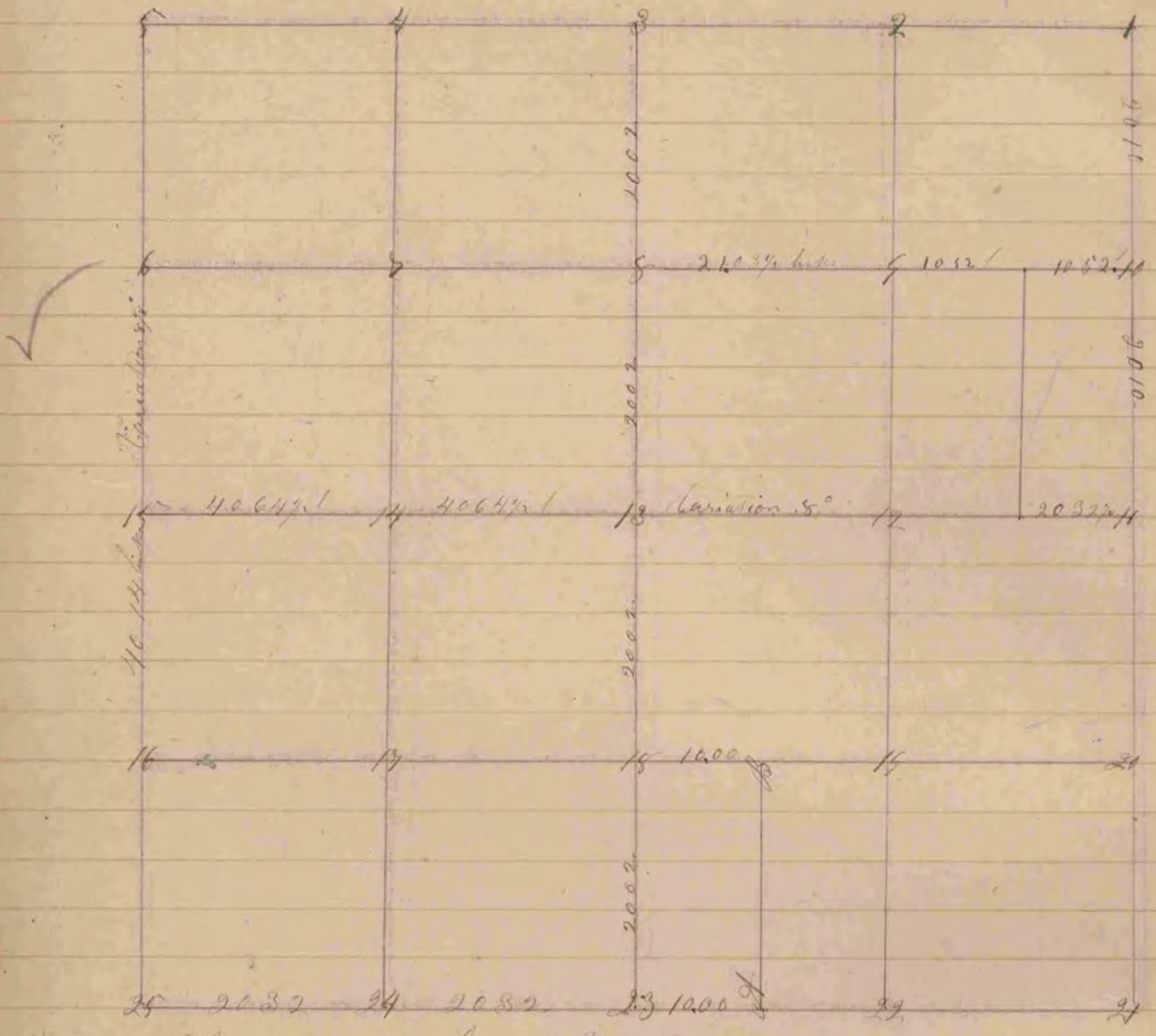

- Fig. 14 N 67° W. 0.36 S 27° W 27  
 .. 30 S 51° E 125  
 24 Br. 0 20 S 37° W 115.63  
 .. 24 S 57° W 115 Fig 12 Br. 0 12 S 27° W 92 1/2  
 " 8 .. 20 S 18° W 84 1/2 Br. 0 20 S 32° E 106  
 .. 24 S 73° E 169  
 10 W. 0.30 S 25 1/2 E 63  
 36 S 11° W 141 1/2  
 7 Br. 0 12 S 47° E 23 1/2  
 .. 24 S 36° E 51

13 State or Marsh

The above survey was made the fourth and fifth days of March  
 1856.

Joseph Church

County Surveyor  
 Rock County Wis